

Ersatzteilverzeichnis P72/320-100R
Spare Parts List

Best.-Nr.: 00.6011
Code Nr.

| Lfd. Nr. Item No. | Stückzahl No. Off | Best.-Nr. Code No. | Benennung | Description |
|----------------------|----------------------|-----------------------|----------------------------|-----------------------------|
| 1 | 1 | 01.0787 | Antriebsgehäuse | Crankcase |
| 2 | 1 | 00.2914 | Ölauffüllstopfen kpl. | Oil Filler Plug Assy |
| 4 | 1 | 03.0198 | Getriebebedeckel | Crankcase Cover |
| 5 | 1 | 06.0531 | Dichtung zu 4 | Seal for 4 |
| 8 | 1 | 00.1008 | Ölmeßstab | Oil Dipstick |
| 9 | 1 | 06.0053 | O-Ring zu 8 | O-Ring for 8 |
| 10 | 12 | 21.0400 | Innensechskantschraube | Inner Hexagon Screw |
| 11 | 12 | 07.3196 | Federring | Spring Washer |
| 12 | 3 | 07.1780 | Ablaßstopfen | Drain Plug |
| 13 | 2 | 06.0282 | Dichtung zu 12 | Seal for 12 |
| 14 | 2 | 03.0196 | Lagerdeckel | Bearing Cover |
| 15 | 2 | 06.0514 | Radialwellendichtring | Radial Shaft Seal |
| 16 | 2 | 06.0248 | O-Ring zu 14 | O-Ring for 14 |
| 20 | 2 | 05.0118 | Kegelrollenlager | Taper Roller Bearing |
| 20A | 1-5 | 07.1669 | Paßscheibe | Fitting Disc |
| 21 | 1 | 03.0208 | Wellenschutz | Shaft Protector |
| 22 | 1 | 11.0678 | Kurbelwelle | Crankshaft |
| 23 | 1 | 07.1671 | Paßfeder | Fitting Key |
| 24 | 3 | 00.4669 | Gleitlagerpleuel kpl. | Connecting Rod Assy |
| 25 | 3 | 00.4665 | Kreuzkopf kpl. | Crosshead Assy |
| 28 | 3 | 11.0676 | Kreuzkopfbolzen | Crosshead Pin |
| 30 | 1 | 03.0311 | Abdeckplatte | Cover Plate |
| 30A | 4 | 21.0256 | Sechskantschraube | Hexagon Screw |
| 30B | 4 | 08.0132 | Durchführungstülle | Grommet |
| 30C | 4 | 07.3512 | Scheibe | Disc |
| 31 | 1 | 07.1628 | Transporthaken | Eye Bolt |
| 32 | 3 | 06.0532 | Radialwellendichtring | Radial Shaft Seal |
| 33 | 3 | 07.3658 | Dichtungsaufnahme | Seal Retainer |
| 33A | 3 | 06.1212 | O-Ring zu 33 | O-Ring for 33 |
| 33B | 3 | 07.3421 | Seegerring zu 33 | Circlip for 33 |
| 33C | 3 | 07.4058 | Paßscheibe | Fitting Disc |
| 34 | 3 | 07.1764 | Ölabstreifer | Oil Scraper |
| 36 | 3 | 00.6013 | Plungerrohr kpl. (36A-36D) | Plunger Pipe Assy (36A-36D) |
| 36A | 3 | 07.1576 | Plungerverschraubung | Plunger Connection |
| 36B | 3 | 11.0707 | Plungerrohr | Plunger Pipe |
| 36C | 3 | 21.0206 | Spannschraube | Tensioning Screw |
| 36D | 3 | 06.0780 | Cu-Dichtring | Copper Ring |
| 37 | 1 | 01.0789 | Zwischengehäuse | Intermediate Casing |
| 38 | 3 | 07.4565 | Dichtungsaufnahme | Seal Sleeve |
| 39 | 3 | 06.1598 | O-Ring zu 33 | O-Ring for 33 |
| 40 | 3 | 07.4566 | Druckring | Pressure Ring |
| 41 | 3 | 07.4567 | Leckagerückfuhring | Drip-Return Ring |
| 42 | 3 | 06.1597 | O-Ring | O-Ring |
| 43 | 3 | 07.4093 | Druckring | Pressure Ring |
| 44 | 9 | 06.1482 | Manschette | Sleeve |
| 45 | 3 | 07.4094 | Manschettensstützring | Sleeve Support Ring |
| 46 | 3 | 07.4170 | Dichtungsspannfeder | Seal Tension Spring |
| 47 | 3 | 07.4568 | Dichtungskassette | Seal Case |
| 47A | 6 | 06.1377 | O-Ring | O-Ring |
| 48 | 1 | 01.0791 | Druckgehäuse | Discharge Casing |
| 49 | 8 | 21.0535 | Stiftschraube | Stud Bolt |
| 49A | 8 | 07.3409 | Sechskantmutter | Hexagon Nut |
| 50 | 1 | 01.0790 | Ventilgehäuse | Valve Casing |
| 50A | 4 | 07.3066 | Zylinderstift | Cylinder Stud |
| 51A | 6 | 07.3654 | Ventilsitz | Valve Seat |
| 51B | 6 | 06.0582 | O-Ring zu 51 | O-Ring for 51 |
| 51C | 6 | 07.3640 | Ventilplatte | Valve Plate |
| 51D | 6 | 07.2731 | Ventilfeder | Valve Spring |
| 51E | 6 | 07.3641 | Federspannschale | Spacer Pipe |
| 51F | 6 | 07.4096 | Ventilfederführung | Valve Spring Guide |
| 52 | 3 | 07.3651 | Druckventilaufnahme | Pressure Valve Adaptor |
| 52A | 6 | 06.0583 | O-Ring | O-Ring |
| 53 | 6 | 07.3176 | Spannfeder | Tension Spring |
| 54 | 8 | 21.0598 | Innensechskantschraube | Inner Hexagon Screw |
| 55 | 1 | 07.4397 | LRF-Stutzen | Drip-Return Connection |
| 55A | 1 | 07.1558 | Knebelkerbstift | Serrated Pin |
| 56 | 1 | 07.4396 | LRF-Stopfen | Drip-Return Plug |
| 57 | 2 | 06.0245 | O-Ring | O-Ring |
| 58 | 2 | 06.1548 | Leckagedichtung | Leakage Seal |
| 59A | 1 | 06.0815 | Stahl-Dichtring | Steel Ring |
| 60 | 1 | 07.1760 | Verschlußstopfen G1 1/4 | Plug G1 1/4 |
| 61 | 1 | 07.2286 | Verschlußstopfen G2 1/2 | Plug G2 1/2 |
| 66 | 1 | 07.3211 | Scheibe für Kurbelwelle | Disc for Crankshaft |
| 67 | 1 | 21.0394 | Sechskantschraube | Hexagon Screw |
| | 1 | 15.0038 | Montagewerkzeug | Mounting Aid |
| | 6 | 00.5025 | Ventil kpl. (51A-F) | Suction Valve Assy (51A-F) |

Bei Bestellung von Ersatzteilen bitte Bestell-Nr., Pumpen-Nr. und -type angeben
 When ordering please state Code No., Pump Model and Pump Serial No.

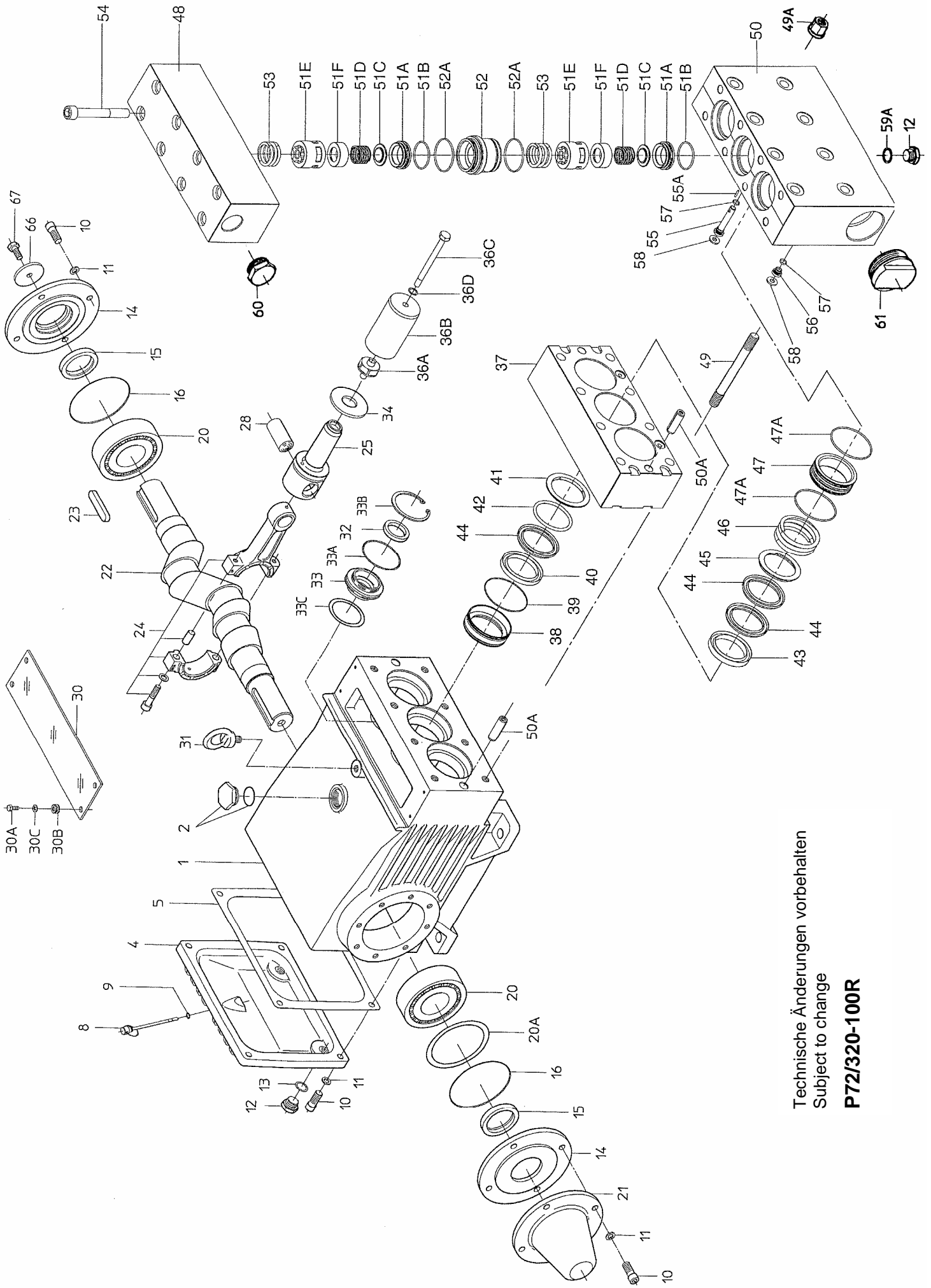

Technische Änderungen vorbehalten
 Subject to change
P72/320-100R